



RESOLUTION No. 22-584

OF THE BOARD OF SUPERVISORS OF THE COUNTY OF NEVADA

RESOLUTION APPROVING ADDENDUM 1 TO THE LICENSE AGREEMENT WITH PACIFIC GAS AND ELECTRIC COMPANY FOR USE OF THE GRASS VALLEY VETERANS MEMORIAL BUILDING AS A COMMUNITY RESOURCE CENTER AND STAGING AREA AND AUTHORIZING THE DIRECTOR OF FACILITIES MANAGEMENT TO SIGN THE ADDENDUM (FACILITIES MANAGEMENT)

WHEREAS, on June 14, 2022, through Resolution 22-274, the Board approved a license agreement with Pacific Gas and Electric Company (PG&E) for use as a community resources center and staging area during and an emergency event defined as Public Safety Power Shutoff Events; and

WHEREAS, the areas identified within the Grass Valley Veterans Memorial Building are first floor lobby, dining, and parking spaces for the community resource center and staging area; and

WHEREAS, both parties wish to amend the license agreement to expand the definition of "Emergency Event" to include events, natural or human-caused, that requires an emergency response to protect life or property. Examples of Emergency Events include but are not limited to a significant earthquake, wildland fire, major heat event or winter storm requiring a warming or cooling center, wind event of over forty (40) miles per hour, major gas leak or gas-related fire, cyber incident that slows system response times, or other events of this scale. For an Emergency Event, PG&E shall be subject to the same PSPS Event terms and conditions set forth in the License; and

WHEREAS, the License Agreements will help achieve one of the Objectives of the Board of Supervisors 2022 Board Objectives adopted in February 2022 through Resolution 22-092 to "Lead the community in all hazards planning, preparedness, response, and recovery with a focus on wildfire..."; and

WHEREAS, all other terms and conditions of the license remain in effect. We are requesting that the Director of Facilities Management be authorized to execute this Addendum to the License Agreement.

NOW, THEREFORE, BE IT HEREBY RESOLVED by the Board of Supervisors of the County of Nevada, State of California, that the Board of Supervisors hereby approves in the forms attached hereto, the Addendum License Agreement between PG&E and Nevada County for the exclusive use of the Grass Valley Veterans Memorial Building per Exhibit A as community resource center and staging area during Emergency Events and that the Director of Facilities Management is hereby authorized to execute the Addendum to License Agreement on behalf of the County of Nevada.

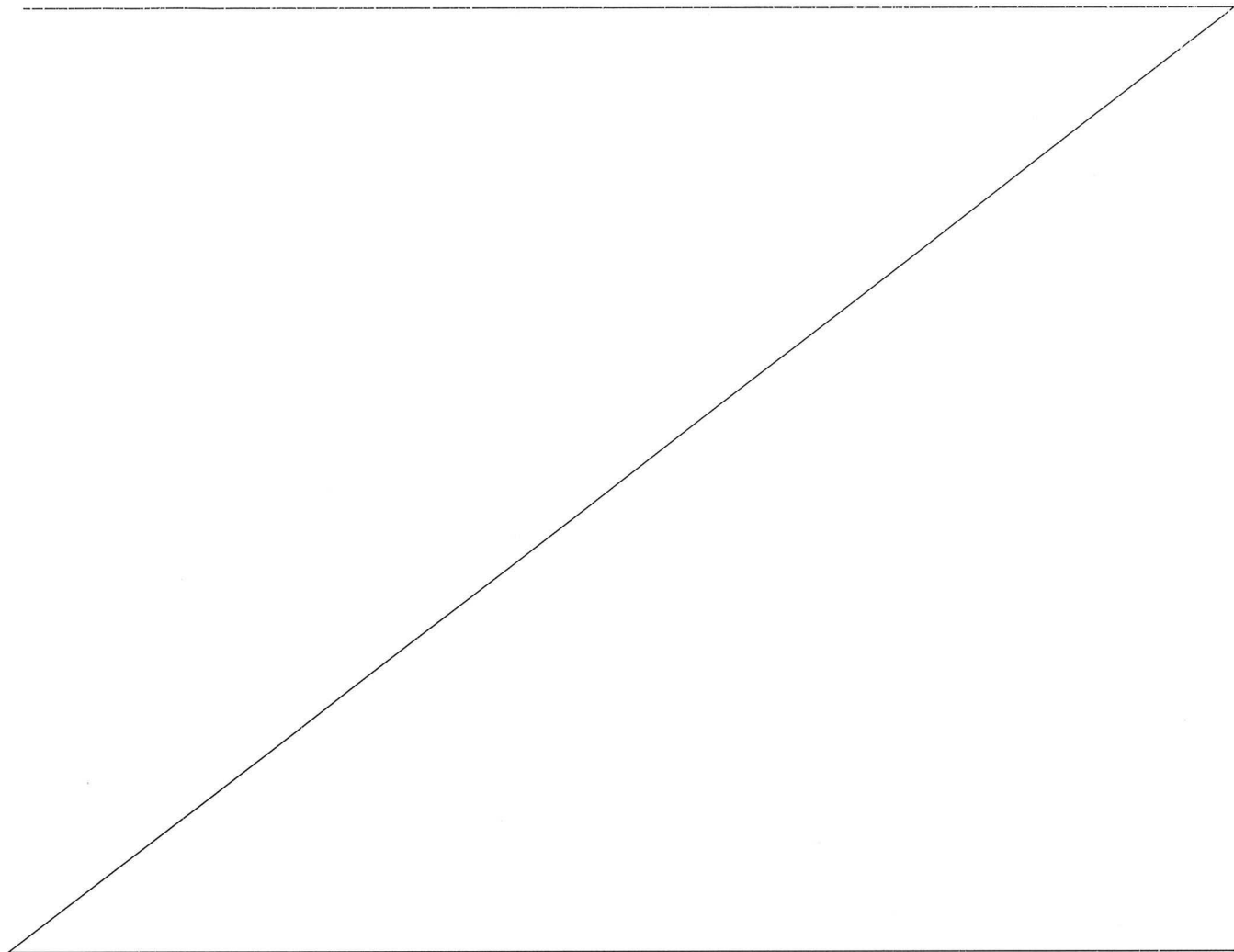

PASSED AND ADOPTED by the Board of Supervisors of the County of Nevada at a regular meeting of said Board, held on the 6th day of December, 2022, by the following vote of said Board:

- Ayes: Supervisors Heidi Hall, Edward Scofield, Dan Miller, Susan K. Hoek and Hardy Bullock.
- Noes: None.
- Absent: None.
- Abstain: None.

ATTEST:

JULIE PATTERSON HUNTER
Clerk of the Board of Supervisors

By: 

Susan K. Hoek, Chair

12/6/2022 cc: Facilities*
AC*

ADDENDUM TO LICENSE AGREEMENT (PUBLIC SAFETY POWER SHUTOFF)

This Addendum to the LICENSE AGREEMENT (PUBLIC SAFETY POWER SHUTOFF) ("License") dated June 14, 2022 is entered into by and between COUNTY OF NEVADA ("LICENSOR") and Pacific Gas and Electric Company, a California corporation, ("PG&E").

Through this Addendum, PG&E desires, and LICENSOR is willing, to modify the License regarding the certain real property commonly known as GRASS VALLEY VETERANS MEMORIAL BUILDING, located at 255 South Auburn Street, Assessor's Parcel Number 08-460-39-000, hereinafter called the "Property," located in the City of Grass Valley, County of Nevada, State of California, and grant the additional rights as follows:

LICENSOR grants to PG&E, PG&E's Representatives, and PG&E's customers the right to use the License Area and certain interior areas of the Property in connection with an Emergency Event. For purposes of this License Agreement, an "Emergency Event" means an event, natural or human-caused, that requires an emergency response to protect life or property and is not a PG&E designated Public Safety Power Shutoff event. Examples of Emergency Events include but are not limited to a significant earthquake, wildland fire, major heat event or winter storm requiring a warming or cooling center, wind event of over forty (40) miles per hour, major gas leak or gas-related fire, cyber incident that slows system response times, or other events of this scale.

For an Emergency Event, PG&E shall be subject to the same PSPS Event terms and conditions set forth in the License.

NOW, THEREFORE, PG&E and LICENSOR agree that the License shall be modified in the manner and to the extent hereinbefore stated and LICENSOR hereby grants to PG&E the rights necessary to effect such modification.

Except as expressly set forth herein, this Addendum shall not in any way alter, modify, or terminate any provision of the License.

This Addendum may be executed by electronic signature(s) and transmitted either by facsimile or in a portable document format ("pdf") version by email and such electronic signature(s) shall be deemed as original for purposes of this Addendum and shall have the same force and effect as a manually executed original.

"PG&E"

"LICENSOR"

PACIFIC GAS AND ELECTRIC COMPANY,
a California corporation

COUNTY OF NEVADA, a political
subdivision of the State of California

By: _____

By: _____

Name: Donald Kennedy

Name: _____

Its: Manager, Land Acquisition

Its: Facilities Director

Date: _____

Date: _____



RESOLUTION No. 22-274

OF THE BOARD OF SUPERVISORS OF THE COUNTY OF NEVADA

RESOLUTION APPROVING A LICENSE AGREEMENT WITH PACIFIC GAS AND ELECTRIC COMPANY FOR USE OF THE GRASS VALLEY VETERANS MEMORIAL BUILDING AS COMMUNITY RESOURCE CENTER AND STAGING AREA DURING PUBLIC SAFETY POWER SHUTOFF EVENTS (PSPS) FOR A TERM OF SIXTY-SIX AND A HALF MONTHS AND AUTHORIZING THE DIRECTOR OF FACILITIES MANAGEMENT TO SIGN THE LICENSE AGREEMENT (FACILITIES MANAGEMENT)

WHEREAS, Pacific Gas and Electric Company (PG&E) desires to partner with Nevada County (Licensor) in connection with PSPS Events related to wildfire prevention; and

WHEREAS, Licensor will provide use of the Grass Valley Veterans Memorial Building facility first floor lobby, dining area, and parking spaces to PG&E as community resource center and staging area during PSPS events beginning June 14, 2022 and ending December 30, 2027; and

WHEREAS, PG&E will provide and locate a generator onsite at this location as early as June and remove the generator before the end of the calendar year of each year; and

WHEREAS, it is expected PG&E will use the facility as PSPS events as they occur for periods of approximately two (2) to ten (10) days at a time (Use Days) and will reimburse Licensor a Use Day fee of \$800 per day for the Grass Valley Veterans Memorial Building; and

WHEREAS, the License Agreements will help achieve one of the Objectives of the Board of Supervisors 2022 Board Objectives adopted in February 2022 through Resolution 22-092 to "Lead the community in all hazards planning, preparedness, response, and recovery with a focus on wildfire...".

NOW, THEREFORE, BE IT HEREBY RESOLVED by the Board of Supervisors of the County of Nevada, State of California, that the Board of Supervisors hereby approves in the forms attached hereto, the License Agreement between PG&E and Nevada County for the exclusive use of the Grass Valley Veterans Memorial Building per Exhibit A as community resource center and staging area during PSPS Events for a sixty-six and a half (66.5) month term beginning June 14, 2022 and ending December 30, 2027 for a Use Day fee of \$800 per day for the Grass Valley Veterans Memorial Building and that the Director of Facilities Management is hereby authorized to execute the License Agreement on behalf of the County of Nevada.

Revenue Fund: 0101-11007-415-1000/430200

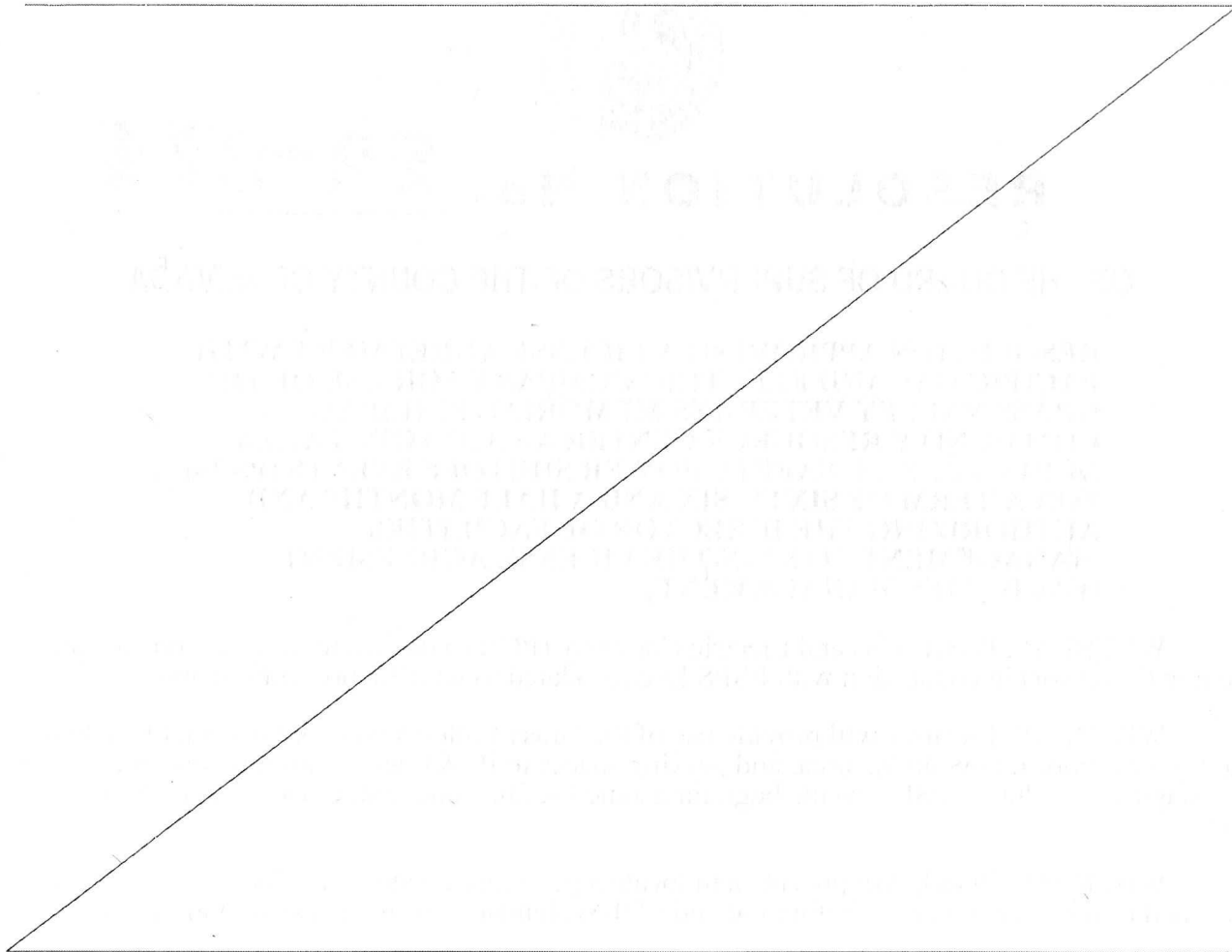

PASSED AND ADOPTED by the Board of Supervisors of the County of Nevada at a regular meeting of said Board, held on the 14th day of June, 2022, by the following vote of said Board:

Ayes: Supervisors Heidi Hall, Edward Scofield, Dan Miller, Susan K. Hoek and Hardy Bullock.

Noes: None.

Absent: None.

Abstain: None.

ATTEST:

JULIE PATTERSON HUNTER
Clerk of the Board of Supervisors

By: 

Susan K. Hoek, Chair

6/14/2022 cc: Facilities*
AC*

LICENSE AGREEMENT
(PUBLIC SAFETY POWER SHUTOFF)

This License Agreement ("**License Agreement**") is made and entered into this 14 day of June, 2022 (the "**Effective Date**") by COUNTY OF NEVADA, a political subdivision of the State of California, hereinafter called "**LICENSOR**," and PACIFIC GAS AND ELECTRIC COMPANY, a California corporation, hereinafter called "**PG&E**."

R E C I T A L S:

A. LICENSOR owns or leases that certain real property commonly known as Grass Valley Veterans Memorial Building, 255 South Auburn Street, Assessor's Parcel Number 08-460-39-000, hereinafter called the "**Property**," located in the City of Grass Valley, County of Nevada, State of California. The Property includes a parking lot ("**Parking Lot**") containing approximately 30+ parking spaces.

B. PG&E desires to partner with LICENSOR in connection with a Public Safety Power Shutoff Event ("**PSPS Event**"). For purposes of this License Agreement, a "**PSPS Event**" means the existence of one or more environmental conditions creating extreme fire danger that results in the shutoff of power for public safety. Examples of PSPS Events include red flag warnings issued by the United States National Weather Service, low humidity levels, high winds, and dry vegetation.

C. The parties desire to memorialize this mutual understanding and agreement for making the Property available to PG&E in connection with a PSPS Event.

NOW, THEREFORE, for good and valuable consideration, LICENSOR and PG&E agree as follows:

1. Grant of License. Subject to the terms and conditions set forth in this License Agreement, LICENSOR grants PG&E, and its employees, contractors, agents, and representatives ("**PG&E's Representatives**") and PG&E's customers the right to use the License Area described in **EXHIBIT A** attached hereto (the "**License Area**") and certain interior areas of the Property in connection with a PSPS Event, together with rights of ingress and egress to and from the License Area, and the right to use certain exterior areas of the Property as set forth below. All of the activities of PG&E and PG&E's Representatives pursuant to this License Agreement are referred to herein as "**PG&E's Activities**."

2. Use of License Area and Interior Common Areas of the Property. During Use Days (as defined in Section 5 below), PG&E and PG&E's Representatives and customers shall have the exclusive right to use the License Area, specifically the lobby and dining area as a customer resource center. Services to be provided in the License Area may include, among other things, providing PG&E customers with water and snacks and the ability to charge phones and get up-to-date information on outages. PG&E and PG&E's Representatives shall have the right to set up tables and chairs in the License Area. In addition to the exclusive use of the License Area, PG&E and PG&E's Representatives and customers shall have the nonexclusive right, during Use Days, to use lobbies, hallways, stairways, elevators (if operational), restrooms, and

other interior common areas of the Property. PG&E and PG&E's Representatives shall also have the right to install temporary directional signage in the common areas of the Property.

3. Staging Area; Parking.

(a) Staging Area. During Use Days, PG&E and PG&E's Representatives shall have the exclusive right to use the exterior area of the Property shown on **EXHIBIT A** (the "**Staging Area**") to support the operation of an indoor customer resource center in the case of a PSPS Event. PG&E and PG&E's Representatives shall have the right to set up tents, install trailers, portable toilets, fencing, and temporary signage, park mobile vehicle units and other vehicles, and deliver and stage equipment, supplies and materials in the Staging Area.

(b) Parking. PG&E and PG&E's Representatives and customers shall have the non-exclusive right to park vehicles in portions of the Parking Lot shown on **EXHIBIT A** during Use Days.

(c) Personnel. PG&E, in its sole discretion, may elect to engage uniformed, unarmed personnel to be present in the Parking Lot and Staging Area during Use Days.

4. Generator. Subject to the terms and conditions of this Section 4, LICENSOR grants PG&E and PG&E's Representatives a license to install, maintain, operate, repair, and replace a generator and related equipment (collectively, the "**Generator**") in the exterior area of the Property shown on **EXHIBIT A** attached hereto (the "**Generator Site**"). At PG&E's option, PG&E or PG&E's Representatives may install fencing, bollards, or other barriers around the Generator Site. LICENSOR grants to PG&E and PG&E's Representatives exclusive use of the Generator Site. PG&E anticipates that the Generator may remain in place from approximately June 1 until December 31 of each year, and PG&E and PG&E's Representatives shall have the right, without prior notice to LICENSOR, to enter the Property at all times to access the Generator. PG&E, at its expense, shall be responsible for obtaining all required permits for the Generator and complying with all laws relating to the Generator. Notwithstanding the definition of PG&E's Activities, the presence of the Generator on the Property and activities related to the Generator shall not be considered PG&E's Activities for purposes of determining Use Days, and PG&E shall not be required to pay any additional license fees or other sum in connection with the Generator. The Generator is solely for the benefit of PG&E and PG&E's customers. PG&E makes no representations or warranties to LICENSOR regarding the operation, capacity, or condition of the Generator, and PG&E shall have no liability to LICENSOR in connection with any failure or malfunction of the Generator. Promptly after the expiration of the term of this License Agreement, PG&E or PG&E's Representatives shall remove the Generator and any barriers installed by PG&E or PG&E's Representatives.

5. Term. This License Agreement shall be for a term of five (5) years six and a half months, commencing on June 14, 2022 (the "**Commencement Date**"), and expiring on December 30, 2027 (the "**Termination Date**"). Notwithstanding the term of this License Agreement, PG&E anticipates that it will use the License Area and the Staging Area on an occasional basis, if at all, for periods of approximately two (2) to ten (10) days at a time. The days (including any partial days) during which any of PG&E's Activities are occurring in or on the License Area or the Staging Area are referred to herein as "**Use Days**." During Use Days,

PG&E shall have the exclusive right to use the License Area and the Staging Area twenty-four (24) hours per day.

6. License Fee. PG&E shall pay a license fee ("**License Fee**") of Eight Hundred Dollars (\$800) per day for each Use Day.

7. Priority Scheduling. PG&E shall give LICENSOR at least eight (8) hours' prior notice (the "**PSPS Notice**") of the dates and times that PG&E desires to access and use the Property in connection with a PSPS Event. Within four (4) hours after receipt of a PSPS Notice, LICENSOR shall confirm receipt of the PSPS Notice. PG&E's use of the Property in connection with a PSPS Event shall take priority over other uses and events. If another use or event is scheduled at the Property that would conflict with PG&E's use of the Property during the dates and times specified in the PSPS Notice, LICENSOR shall cancel such event and indemnify and defend PG&E from any and all Claims related to such cancellation. LICENSOR acknowledges that PG&E may give LICENSOR multiple PSPS Notices during any calendar year.

8. Use of License Area and Staging Area.

(a) As Is. To LICENSOR'S current actual knowledge, the Property complies with all laws, including the Americans with Disabilities Act and other accessibility laws. PG&E accepts the License Area and the Staging Area "AS-IS," "WHERE-IS" and "WITH ALL-FAULTS," subject to all applicable zoning, municipal, county and state laws, ordinances, and regulations governing and regulating the use of the License Area and the Staging Area. PG&E may request LICENSOR to perform alterations, repairs, or improvements to the License Area and the Staging Area, but PG&E understands and agrees that LICENSOR shall not be obligated to make any such alterations, repairs or improvements at any time. Except in the event of an emergency, PG&E shall not make any alterations, repairs or improvements to the Property without the prior written consent of LICENSOR, which consent shall not be unreasonably withheld, conditioned or delayed.

(b) Use. PG&E shall exercise reasonable care in the conduct of PG&E's Activities in the License Area and the Staging Area. Without limiting the generality of the preceding sentence, PG&E shall maintain the License Area and the Staging Area in reasonably neat and orderly condition during Use Days; provided, however, that LICENSOR, as part of the License Fee and without additional compensation, shall provide all necessary janitorial services to the License Area and common areas during Use Days, including, but not limited to, removing trash and stocking restrooms with supplies. PG&E shall not use the License Area or the Staging Area or permit anything to be done in or about the License Area or the Staging Area during Use Days that will in any way conflict with any law, statute, zoning restriction, ordinance or governmental rule or regulation or requirement relating to the use or occupancy of the License Area or the Staging Area. During Use Days, PG&E shall not allow the License Area or the Staging Area to be used for any unlawful or objectionable purpose, nor shall PG&E cause, maintain or permit any nuisance in, on or about the License Area or the Staging Area.

(c) Mechanic's Liens. PG&E shall keep the Property free and clear of all mechanic's liens arising, or alleged to arise, in connection with any work performed, labor or materials supplied or delivered, or similar activities performed by PG&E or at PG&E's request or

for PG&E's benefit. If any mechanic's liens are placed on the Property in connection with PG&E's use or PG&E's Activities, PG&E shall diligently pursue all necessary actions to remove such liens from title, either by payment or by recording a lien release bond in the manner specified in California Civil Code Section 8424 or any successor statute.

(d) Restoration. Upon PG&E's ceasing to use the License Area and the Staging Area in connection with a particular PSPS Event, PG&E shall remove all personal property of PG&E from the License Area, remove all vehicles, personal property, debris and waste material of PG&E and PG&E's Representatives from the Staging Area, and repair and restore the License Area and the Staging Area as nearly as reasonably possible to the condition that existed prior to PG&E's entry hereunder.

9. Notices. All notices under this License Agreement shall be sent by email to the addresses set forth in **EXHIBIT B**. In addition, LICENSOR will provide PG&E with telephone or cellphone numbers of staff in calling order to contact in an emergency as set forth in **EXHIBIT B**. **EXHIBIT B** shall be updated as needed to reflect current names and contact information.

10. Indemnity. Except to the extent caused by the negligence or willful misconduct of LICENSOR, its officers, agents, or employees, PG&E shall indemnify, defend and hold harmless LICENSOR and its governing body, officers, agents, and employees from and against all claims, losses, actions, demands, damages, costs, expenses (including, but not limited to, reasonable attorneys' fees and court costs) (collectively, "**Claims**") that are caused by PG&E's Activities, or the entry on, occupancy or use of, the Property by PG&E or PG&E's Representatives under this License Agreement, including, but not limited to, Claims relating to (i) injury to or death of persons, including, but not limited to, employees of LICENSOR or PG&E; (ii) injury to the property of LICENSOR, and (iii) violation of any applicable federal, state, or local laws, statutes, regulations, or ordinances by PG&E or PG&E's Representatives. In no event, however, shall PG&E be liable for any indirect or consequential damages or for loss of profits or other revenue, loss of goodwill, or loss of use. The indemnification obligations of PG&E under this Section 10 shall survive the expiration or earlier termination of this License Agreement.

11. Insurance. PG&E shall at all times during the Term of this License Agreement, self-insure for PG&E's Activities pursuant to this License Agreement in accordance with **EXHIBIT C**.

12. Alterations to Property. LICENSOR hereby grants PG&E and PG&E's Representatives the right to perform, at PG&E's expense, the alterations to the Property described in **EXHIBIT D** attached hereto. PG&E or PG&E's Representatives will coordinate the scheduling of the performance of such alterations with LICENSOR.

13. Miscellaneous.

(a) Governing Law. This License Agreement shall in all respects be interpreted, enforced, and governed by and under the laws of the State of California.

(b) Attorneys' Fees. Should either party bring an action against the other party, by reason of or alleging the failure of the other party with respect to any or all of its obligations hereunder, whether for declaratory or other relief, and including any appeal thereof, then the party which prevails in such action shall be entitled to its reasonable attorneys' fees and expenses related to such action, in addition to all other recovery or relief.

(c) No Waiver. Any waiver with respect to any provision of this License Agreement shall not be effective unless in writing and signed by the party against whom it is asserted. The waiver of any provision of this License Agreement by a party shall not be construed as a waiver of a subsequent breach or failure of the same term or condition or as a waiver of any other provision of this License Agreement.

(d) Counterparts. This License Agreement may be executed in identical counterpart copies, each of which shall be an original, but all of which taken together shall constitute one and the same agreement.

(e) Authority. Each party to this License Agreement warrants to the other that it has the right and authority to enter into and to perform its obligations under this License Agreement, without the consent of any third party, and that the person signing below is authorized to bind such party.

(f) Interpretation. This License Agreement shall be construed according to the fair meaning of its language. The rule of construction to the effect that ambiguities are to be resolved against the drafting party shall not be employed in interpreting this Agreement.

(g) Exhibits. The following exhibits are attached hereto and incorporated herein by this reference:

EXHIBIT A – License Area

– Staging and Parking Lot Area

– Generator Site

EXHIBIT B – Notices

EXHIBIT C – Statement of Self-Insurance Program

EXHIBIT D – ADA and Electrical Alterations

(h) Electronic Signatures. This License Agreement may be executed by electronic signatures (*e.g.*, using DocuSign or e-SignLive) or signatures transmitted in portable document format ("pdf"), and copies of this License Agreement executed and delivered by means of electronic or pdf signatures shall have the same force and effect as copies hereof executed and delivered with original manually executed signatures. The parties may rely upon electronic and pdf signatures as if such signatures were manually executed originals and agree that an electronic or pdf signature page may be introduced into evidence in any proceeding arising out of or related to this License Agreement as if it were an original manually executed signature page.

(i) Successors and Assigns. This License Agreement shall be binding upon and inure to the benefit of the heirs, personal representatives, successors, and assigns of each party.

(j) Entire Agreement. This License Agreement supersedes all previous oral and written agreements between and representations by or on behalf of the parties and constitutes the entire agreement of the parties with respect to the subject matter hereof. This License Agreement may not be amended, except by a written agreement executed by both parties.

IN WITNESS WHEREOF, the parties have executed this License Agreement as of the date set forth below each signature, effective upon the Effective Date first written above.

"PG&E"

"LICENSOR"

PACIFIC GAS AND ELECTRIC COMPANY,
a California corporation

COUNTY OF NEVADA,
a political subdivision of the State of California

By: Donald Kennedy
Donald Kennedy (Jul 26, 2022 08:56 PDT)

By: Justin Drinkwater
Justin Drinkwater (Jul 28, 2022 09:56 PDT)

Name: Donald Kennedy

Name: Justin Drinkwater

Its: Manager, Land Acquisition

Its: Director of Facilities

Date: 07/26/2022

Date: 07/28/2022

EXHIBIT A

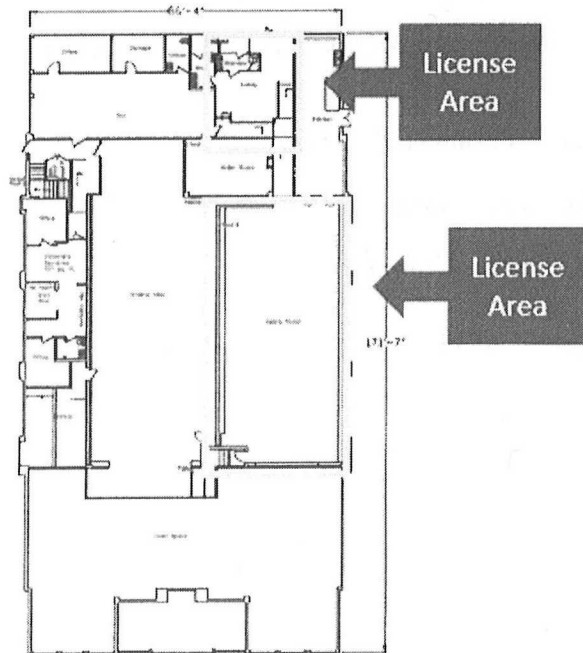
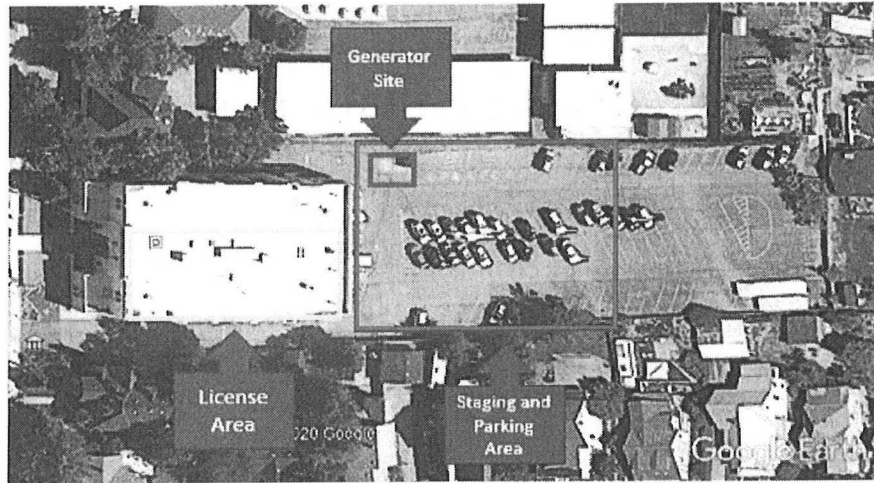

Grass Valley Vets - Basement Level

EXHIBIT B

NOTICES

TO LICENSOR:

Any notice to Licensor, including the notice to be given pursuant to Section 2 of the License Agreement, shall be sent to Jay Smedley at the following email address:

Email address: Jay.Smedley@nevadacountyca.gov Phone Number: _____

In addition, in the event of an emergency, PG&E shall contact the following persons in the calling order set forth below:

1st _____ Phone: _____

2nd _____ Phone: _____

Weekends and After Hours: _____

TO PG&E:

Any notice to PG&E, including the notice pursuant to Section 7 of the License Agreement shall be sent to Jessica Melton at the following email address: Jessica.Melton@pge.com, cc'ing CRCHelp@pge.com.

PG&E contacts for use during emergency use and post emergency for claims and reimbursements:

Jessica Melton, Land Consultant, PG&E
(925) 655-7085 – cell
Jessica.Melton@pge.com – email

Alex Grant, Program Manager, PG&E
(707) 331-2466 – cell
Alex.Grant@pge.com – email

EXHIBIT C

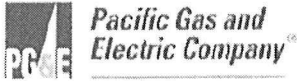

ERM & Insurance Department
245 Market Street, N45
4th Floor
San Francisco, CA 94105

STATEMENT OF SELF-INSURANCE PROGRAM

April 1, 2021

Issued to: Whom it May Concern

Re: Insurance requirements for Pacific Gas and Electric Company (PG&E) to use property for the purposes of establishing and operating a Community Resource Center in the case of a Public Safety Power Shutoff Event (PSPS).

This letter certifies PG&E is insured under a major risk management program with large self-insured retentions. The program provides coverage for the insurance types and limits reflected in the agreement which includes:

- Commercial General Liability: \$5,000,000 each occurrence / \$10,000,000 aggregate
- Employer's Liability: \$1,000,000 each accident
- Business Auto Liability: \$1,000,000 each accident

Further, PG&E has qualified as a self-insurer under the laws of the State of California with respect to Workers' Compensation. Our identification number for this purpose is 2-0012-01-099.

*Please note a certificate of insurance is not applicable when an entity is self-insured, such as PG&E.

Stephen Cairns
Vice President and Chief Audit Officer



SI Certification Letter
File: PGE-246.01

EXHIBIT D

ADA AND ELECTRICAL ALTERATIONS

SCOPE OF ELECTRICAL WORK:

- ADD 400AMP TRANSFER SWITCH ON RIGHT SIDE OF GEAR.
- CAMLOCKS TO BE PROVIDED ON THE SIDE OF NEW TRANSFER SWITCH. TRANSFER SWITCH TO POWER ENTIRE BUILDING.
- RECEPTACLE TO BE ADDED FOR GENERATOR BATTERY CHARGER.
- PG&E OUTAGE NEEDED TO MOVE MAINS TO TRANSFER SWITCH.

ADA SCOPE OF WORK:

- ADJUST DOOR CLOSERS - MAX PRESSURE TO OPEN DOOR SHOULD BE NO MORE THAN 5 LBS.
- REPAIR GAPS AND CRACKS WITH CAULKING THAT EXIST AT THE RAMP DOWNSTAIRS. ACCESSIBLE PATH REQUIRES FIRM, STABLE, LEVEL, AND SLIP-RESISTANT SURFACES.