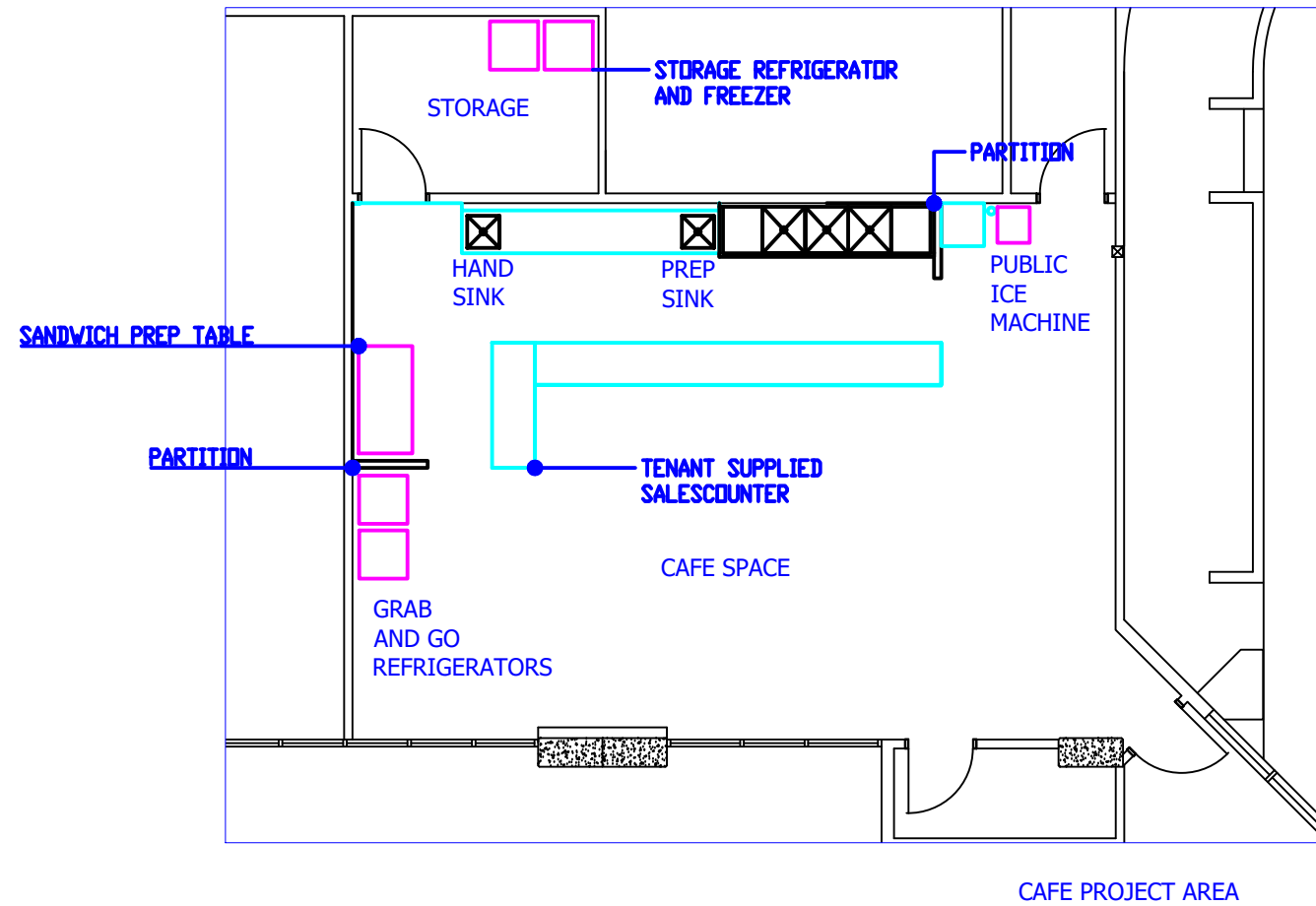
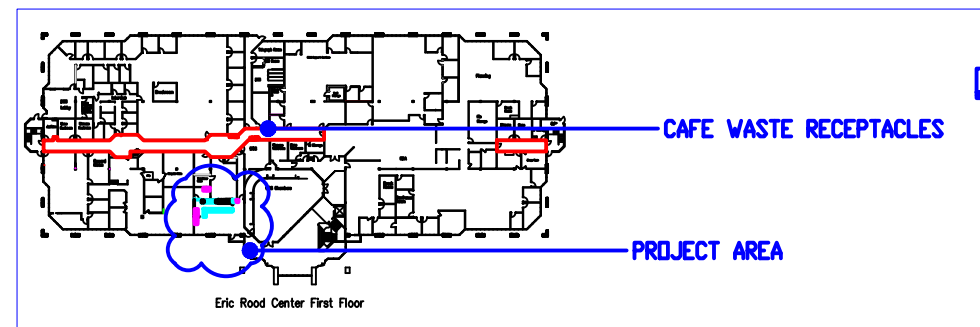

Exhibit 1



SHEET NOTES

1. NORTH, WEST, PARTITION AND STORAGE ROOM WALLS TO BE CLAD IN "MARLITE SYMMETRIX SMARTSEAM" FRP PANELS.
2. EXISTING TILE AND RUBBER BASEBOARD TO BE REPLACED WITH SANITARY COVE CERAMIC TILE BASEBOARD.
3. EXISTING CABINETS TO BE REPLACED WITH PAINTED WOOD CABINETS COVERED WITH LAMINATED COUNTERTOPS.
4. TENANT SUPPLIED SALES COUNTER TO HAVE FOOD SAFE WORK SURFACES.
5. HAND WASH SINK TO HAVE HANDS FREE FAUCET, SOAP AND TOWEL DISPENSERS.
6. CEILING TILES IN STORAGE ROOM AND ABOVE FOOD SERVICE AREAS TO BE REPLACED WITH "ARMSTRONG KITCHEN ZONE" IN A SMOOTH FINISH.
7. PUBLIC ICE MACHINE IS NOT FOR TENANT USE.
8. WASTE AND RECYCLABLES FROM CAFE ARE TO BE PLACED IN RECEPTACLES IN THE HALLWAY NORTH OF THE SPACE. THESE RECEPTACLES ARE EMPTIED DAILY BY COUNTY STAFF.
9. SANDWICH PREP TABLE TO HAVE CUTTING BOARD TO BE RESURFACED TO A SMOOTH AND SANITARY CONDITION.



SITE PLAN

General Notes		
No.	Revision/Issue	Date
<small>Firm Name and Address</small> NEVADA COUNTY FACILITIES 10014 N. BLOOMFIELD RD. NEVADA CITY, CA 95959		
<small>Project Name and Address</small> COUNTY CAFE UPDATE 950 MAIDU AVENUE NEVADA CITY, CA 95959		
<small>Project</small>	<small>Sheet</small>	
Date	MAY 2, 2023	
Scale	NTS	