

SECTION A-A' - Looking North East - Long section through Process Plant & Warehouse

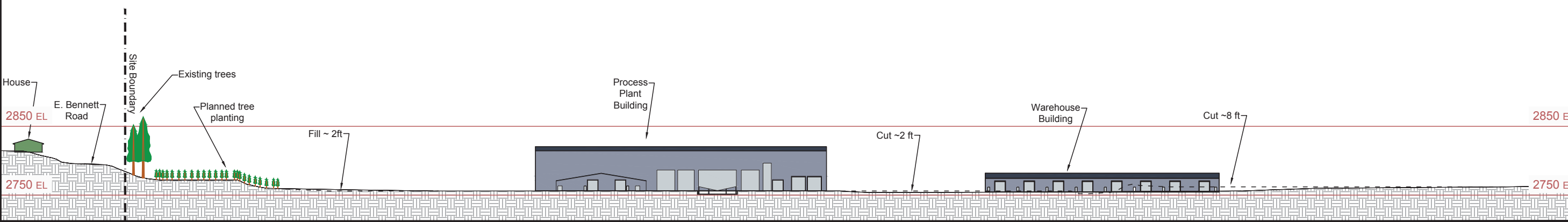

SECTION B-B' - Looking North - Brunswick Shaft

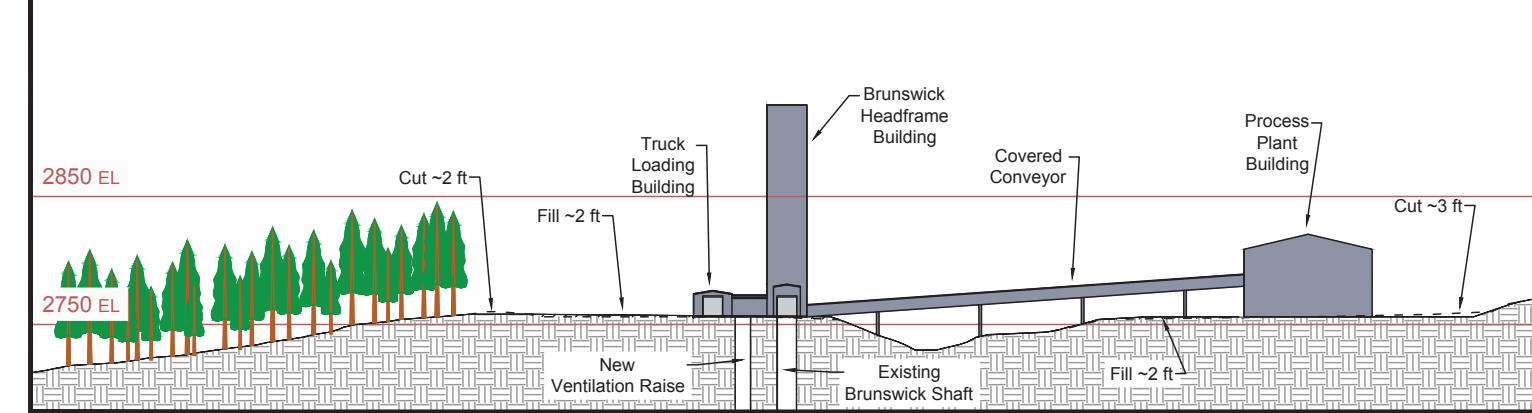

SECTION C-C' - Looking West - Brunswick Shaft

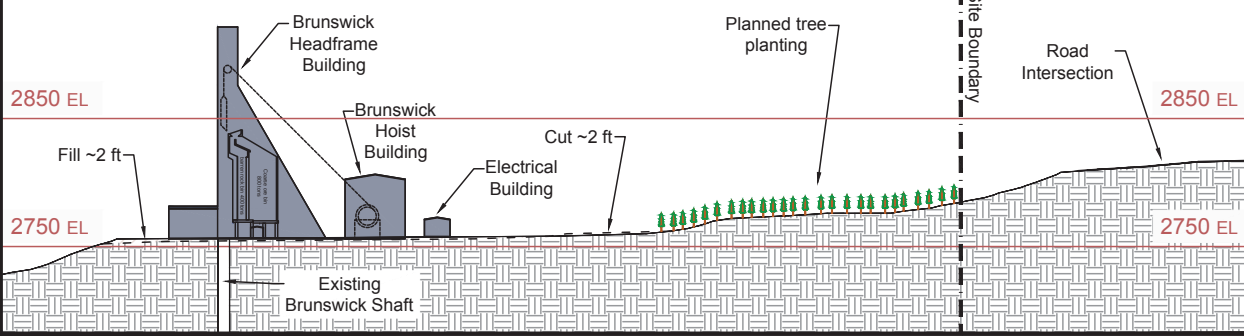

SECTION D-D' - Looking North West - Cross Section Through Process Plant

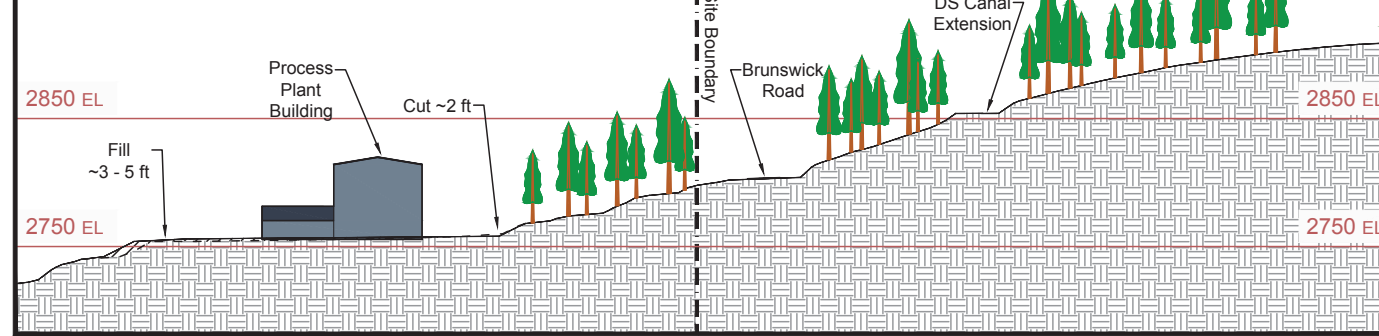

SECTION E-E' - Looking North West - Pond & Process Plant

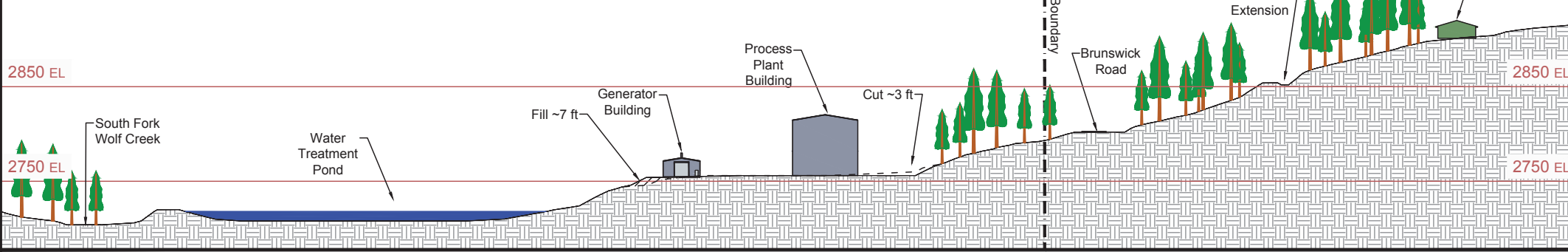

SECTION F-F' - Looking North West - Service Shaft

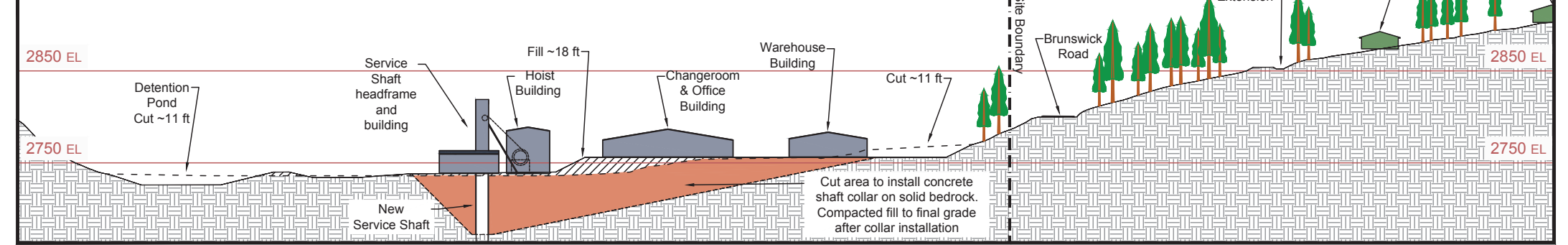

SECTION G-G' - Looking North West - Engineered Fill

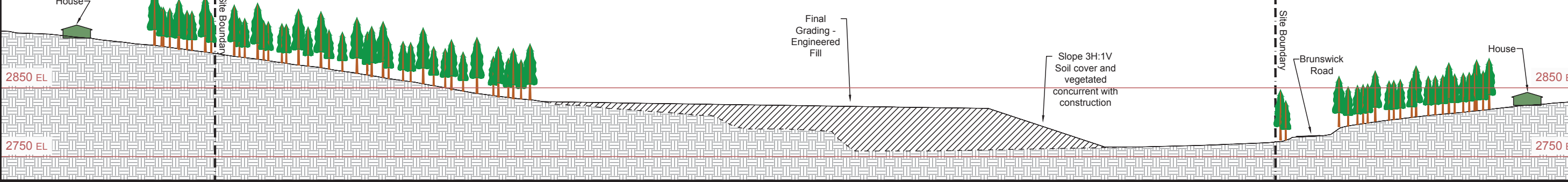

SECTION H-H' - Looking East - Engineered Fill

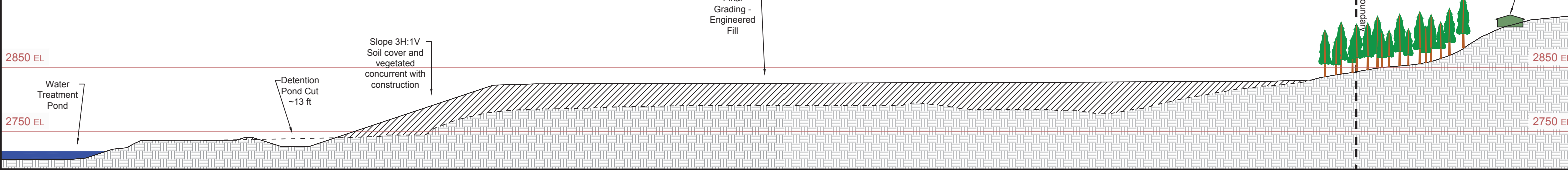

- LEGEND**
- Area of fill excavation planned
 - Area of cut and fill excavation planned
 - Undisturbed ground
 - Planned Structure
 - House location (not drawn to actual geometry)
 - Forested area (not drawn to actual tree heights or spacing)
 - Current / original ground surface
 - Final Ground Surface
 - Property Boundary
- Final grading topography based on:
Preliminary Grading Plan prepared by Nevada City Engineering Inc.

Idaho-Maryland Mine Project
Rise Grass Valley Inc.
 PO Box 271
 Grass Valley, California, USA 95945

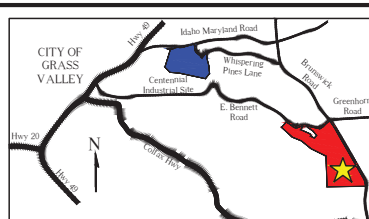

Brunswick Industrial Site
 Nevada County, SEC. 31, T.16N, R.9E., M.D.M
 Total Area = 118.93 Acres
 Assessor Parcel Numbers:
 09-630-37, 09-630-39, 09-441-03, 09-441-04,
 09-441-05, 09-441-34
 Current Zoning M1-SP / Proposed Zoning M1-ME

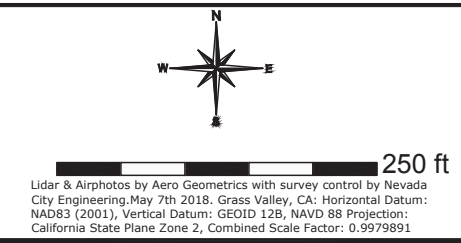

B104 Brunswick Industrial Site Plan
Section Views
 Current and final topography, grading, and structures

Drawn by : Rise Grass Valley - Nov 11 / 19 Scale : 1" = 100 feet